



The Garden Spray



Bulletin of the Men's Garden Club of Minneapolis, Inc.

Affiliated with Gardeners of America and the Minnesota State Horticultural Society

July 1992, Volume 50, Number 7

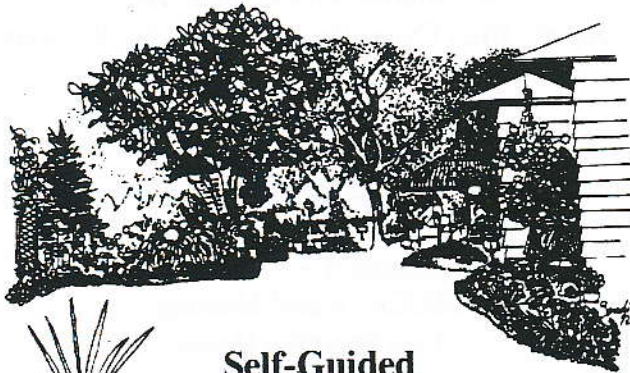
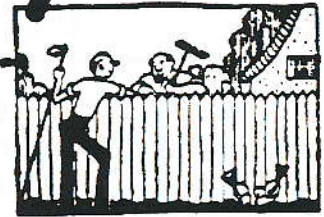

Self-Guided Driving Tour

Saturday & Sunday
July 11 & 12, 1992
noon to 5 p.m.

Bus Tour

Saturday
July 11, 1992
11 a.m. to 4 p.m.

Departs from the parking lot at
Christ Presbyterian Church,
Highway 100 & 70th in Edina

50th Anniversary Garden Tours July 11 & 12

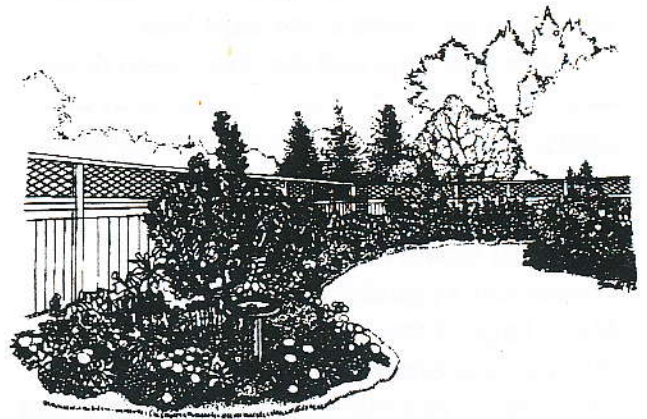

Inside:

Page 2/	Editor's Column
	Events Calendar
Page 3-8/	Flower & Vegetable Show Schedule
Page 9/	President's Column
Page 10/	Planting at Stevens House You Would Have Liked... Archie Flack

Tickets are still available for both tours.
For tickets and tour information call:
922-1302
or 922-6411

Proceeds from tours will be used for
horticulture and landscaping scholarships.

Be sure to send ticket sale funds
and unsold tickets as soon as possible to:
Bob Stepan, 7717 Riverdale Drive,
Brooklyn Park, MN 55444

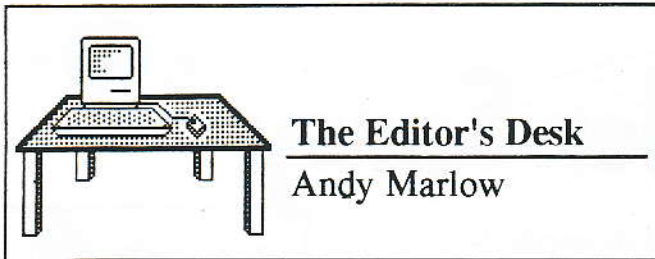

This month brings the first major event in the celebration of the 50th anniversary of the Men's Garden Club of Minneapolis – the 50th Anniversary Garden Tours. As long as this club has existed, members have been visiting each others gardens to borrow ideas, to compare results with their own gardens and just to enjoy the beauty of each garden. There are some spectacular gardens on these tours and the money all goes to a good cause. Enjoy!

And please remember to get your ticket funds and unused tickets in to Bob Stepan as soon as possible. The deadline was July 1, but I'm sure Bob and Tour Chair Dave Johnson won't turn you down a few days later.

Don't be surprised that there is no dinner reservation card attached to this issue of the Spray. Because of the 50th anniversary tours, there will be no regular MGCM meeting this month.

Next month comes the big MGCM Flower and Vegetable Show at St. Anthony Main. Pages 3 through 8 of this issue contain the complete Show schedule so you can plan your entries. Just pull out those pages and fold on the dotted line for a handy pocket-size booklet. It also includes maps that will help orient you to our new location.

It's a fun event and a great way to show off the results of all your hard work this summer. Try to enter at least one specimen, even if you don't think it will win a ribbon. Bring the best thing you've grown. Someone – Show Chair Kent Petterson, Show committee members or fellow competitors – will be happy to give you advice on preparing your exhibit. You might be surprised!

Coming Attractions

July 11 – 11:00 a.m.

Bus Tour

50th Anniversary Garden Tour

Departs from Christ Presbyterian Church, Edina

July 11 & 12

Self-guided Driving

50th Anniversary Garden Tour

August 4 – 7:30 p.m.

MGCM Board Meeting

Don Powell's House

August 8 & 9

MGCM Flower & Vegetable Show

St. Anthony Main

August 9

Time and site to be announced

MGCM Sunday Garden Tour

September 1 – 7:30 p.m.

MGCM Board Meeting

Bob Stepan's House

September 8 – 6:00 p.m.

MGCM Dinner Meeting

Lake Harriet Church

The Garden Spray is published monthly by the Men's Garden Club of Minneapolis, Inc., for its members and friends. The Men's Garden Club of Minneapolis is a not-for-profit, equal opportunity organization.

Editor.....Andrew J. Marlow
Staff.....Mary Maynard,
Robert C. Olson, Terry Robertson

Getting There

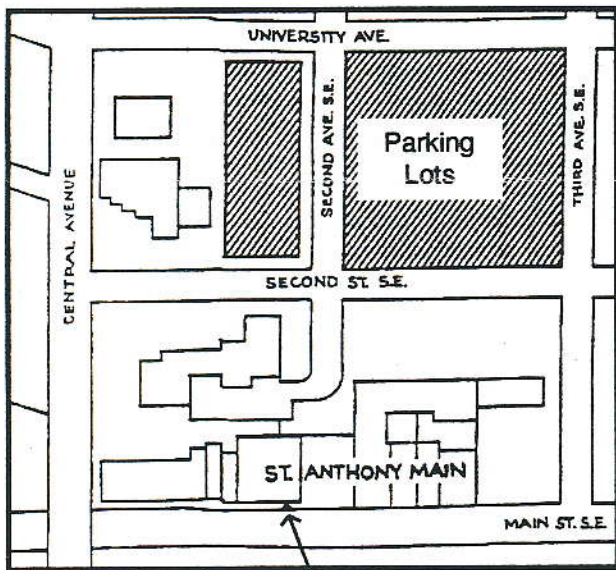
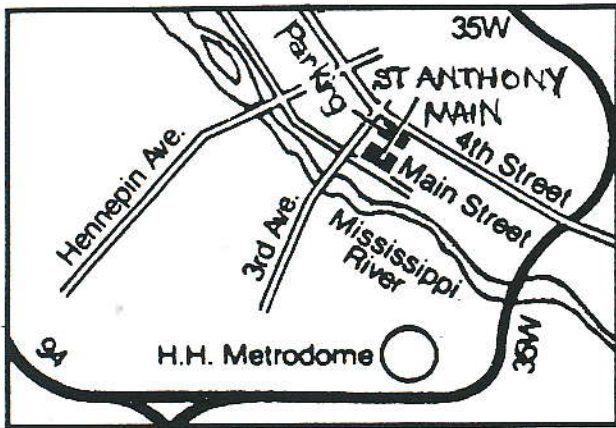

Park in lots indicated or at meters along Main Street or Third Avenue SE

Men's Garden Club of Minneapolis

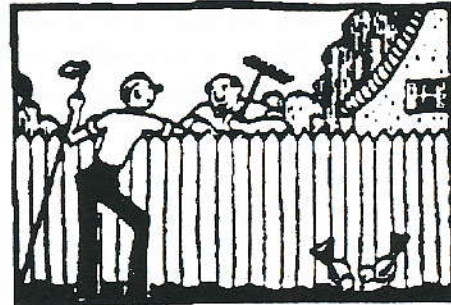

We have ribbons and trophies galore for you to win at our

50TH ANNIVERSARY Flower and Vegetable Show

at

ST • ANTHONY

M A I N

August 8-9, 1992

SATURDAY 10:00-8:00

SUNDAY 12:00-5:00

Any interested person is invited to enter the Men's Garden Club of Minneapolis flower and vegetable show scheduled for August 8-9 at St. Anthony Main. Entries will be accepted between 5:00pm and 9:00pm Friday, August 7 and between 7:00am and 10:00am on Saturday, August 8 at St. Anthony Main. Judging will be between 10:00am and 12:00 noon Saturday, August 8. The show will be open to the public between 10:00am and 8:00pm on Saturday, August 8 and between 12:00 noon and 4:30pm on Sunday, August 9. The show will close at 4:30pm on Sunday, August 9.

PARKING

Use the street cut on Main Street to load and unload materials. Metered parking is available along Main Street and on 3rd Ave. S.E.. Long term parking is available behind St. Anthony Main at 2nd Ave. S.E. and 2nd St. S.E. (See the maps on the last page of this schedule.)



HOW TO ENTER

Section F Class

VEGETABLES

1. A. Beets (3)
- B. Potatoes (3)
 - a. white
 - b. red
 - c. russet
- C. Carrots (3)
 - a. long, tapered
 - b. short
- D. Onion (3)
 - a. yellow
 - b. red
 - c. white
2. A. Cabbage (1)
- B. Cauliflower (1)
- C. Broccoli (1)
3. A. Squash, summer (1)
- B. Squash, winter (1)
- C. Pumpkin (1)
- D. Cantaloupe (1)
- E. Watermelon (1)
- F. Cucumber, slicing (3)
- G. Cucumber, pickling (7)
4. A. Tomatoes, large (3)
- B. Tomatoes, small (7)
- C. Peppers, large (3)
- D. Peppers, small (7)
- E. Beans, bush (7)
 - a. wax
 - b. green
- F. Beans, pole (7)
 - a. wax
 - b. green
- G. Corn, sweet (3)
- H. Any other vegetable at edible stage, small (3)
- I. Any other vegetable at edible stage, large (1)

Section G Class

FRUITS

1. Strawberries (1 pint)
2. Raspberries (1 pint)
3. Any other ripe fruit (3)
4. Any other ripe berry-like fruit (1 pint)
5. 3 stems-all one variety herb named
6. Collection of 5 herbs of a different variety, named each in a separate bottle
7. Container grown, all one variety, named

1. Choose the flower and/or vegetables you want to exhibit.
2. Carefully check the schedule of entries, pay attention to the number of specimen needed.
3. Check in with the registration clerk and sign up for an exhibitor number.
4. Prepare your material for display. Consult other members on the proper procedure.
5. Put your entry on the display table near the number of the appropriate class.
6. Wait until the judging is over and come back to count up your ribbons.
7. If you have questions call Kent Petterson, the committee chairman, at 332-1821.

GENERAL RULES

1. Anyone may enter this flower and vegetable show as an exhibitor and compete for ribbons and prizes.
2. MGCM will be awarding a few special ribbons and trophies to its members. To be eligible for these awards, an exhibitor must be a member in good standing of the club and must register with the garden club and receive an entrance number. In addition to club awards, they will be eligible for non-member awards.
3. MGCM will provide staging items, (i.e. bottles, paper plates, etc.) for horticulture entries.
4. Only 1 entry in each design class per exhibitor, but multiple entries in horticulture are acceptable providing each is a different named variety or kind.
5. Entry tags must be filled out for each entry; include name of specimen, if possible, plus exhibitor's name and address.

6. All possible care will be given to the entries, but the Men's Garden Club of Minneapolis and the management of St. Anthony Main disclaim any liability to loss or damage to private property or specimens entered.
7. Designs (arrangements) must be the work of the exhibitor, and the horticulture entries must have been grown by the exhibitor.
8. Entries must be removed from the show floor after 4:30 pm, Sunday, August 9.
9. The latest edition of the Handbook for Flower Shows by The National Council of State Garden Clubs governs the scoring of the show entries.

AWARDS AND RIBBONS

The following ribbons will be awarded, at the judges discretion:

- First Place - Blue Ribbon
- Second Place - Red Ribbon
- Third Place - White or Yellow Ribbon

Each blue ribbon counts 3 points toward the sweepstakes awards, each red ribbon counts 2 points and each white or yellow ribbon counts 1 point.

The Best of Show and Sweepstakes winners in both the flower and vegetable divisions will be awarded a silver bud vase.

The following will be awarded only to MGCM members:

1992 National Awards

- Vegetable - Green Bean (any)
- Flower - Marigold (any size).

Albert R. Blackburn Trophy Flower Sweepstakes

Tom Foley Memorial Trophy Vegetable Sweepstakes

Robert L. Smith Memorial Trophy Best showing by a First-Time Exhibitor

FOLIAGE

6. Ivys
7. Pothos or Philodendron
8. Ferns
9. Hoya
10. Begonia
11. Any other

SUCCULENTS

12. Euphorbia
13. Sansevieria
14. Pepperomia
15. Aloe
16. Any Crassula
17. Haworthia
18. Any other

CACTI

19. Large, 5" or more in diameter or 10" or more in height
20. Small, less than 5" in diameter or less than 10" in height

CONTAINER GROWN PATIO PLANTS

21. Begonia, fibrous
22. Begonia, tuberous
23. Geranium
24. Coleus
25. Fuschia
26. Impatiens
27. Herbs

COLLECTIONS OF PLANTS

28. Collection of 3 or more foliage or flowering plants
29. Collection of 3 or more cacti or succulents
30. Collection of 3 or more patio plants

HANGING BASKETS

31. Foliage
32. Blooming
33. Outdoor

ARTISTIC ARRANGEMENT OF PLANTS

34. Bonsai
35. Dish Garden
36. Planter
37. Terrarium

Section C **ROSES**
Class

1. Hybrid Tea
 - A. White and near white (1 bloom)
 - B. Yellow (1 bloom)
 - C. Orange (1 bloom)
 - D. Pink (1 bloom)
 - E. Red (1 bloom)
 - F. Mauve (1 bloom)
 - G. Any other (1 bloom)
2. Grandiflora (1 spray)
3. Floribunda (1 spray)
4. Polyantha (1 spray)
5. Miniature (1 spray)
6. Climber (miniature) (1 bloom)
7. Old Garden & Shrub Roses (1 spray)
8. Any other rose not listed (1 specimen)

Section D **BULBS, CORMS, AND TUBERS**
Class

1. Lilies (1 stem)
 - A. Upward facing
 - B. Outward facing
 - C. Downward facing
2. Gladiolus
 - A. Small under 3 1/2" (1 spike)
(100, 200)
 - B. Over 3 1/2" (1 spike)
(300, 400, 500)
3. Dahlias
 - A. Pompon, under 2" (3 blooms)
 - B. Miniature 2-4" (3 blooms)
 - C. B & BB size 4-8" (1 bloom)
 - D. A & AA size over 8" (1 bloom)
4. Tuberous Begonias (1 bloom with foliage)
5. Cannas (1 stalk)
6. Calla (1 stalk)
7. Any other (1 specimen)

Section E **POTTED PLANTS**
Class

FLOWERING

1. African Violet
2. Any other gesneriad
3. Begonia
4. Oxalis
5. Any other

The Grand Champion of the 1992 MGCM Flower and Vegetable Show will be selected from the Horticultural Division entries. This award is open to all exhibitors.

DESIGN DIVISION

RULES FOR DESIGN DIVISION

All Design Division classes will be divided into advanced and amateur groups.

Advanced	Open to all
Amateur	Open to all who have won 5 or less first place awards in the design division of a flower show.

1. All fresh plant materials must be garden grown. House plant foliage is permitted.
2. Artificial flowers, fruits, vegetables and foliage are not permitted.
3. Accessories and supplementary plant materials will be permitted in all design classes.
4. Foliage, seeds, berries, fruits, weeds, grasses, and other natural plant parts will be considered supplementary plant materials.
5. Cut vegetables or fruit will not be allowed.

REMEMBER: READ YOUR SCHEDULE CAREFULLY. THE SCHEDULE IS THE LAW OF THE SHOW.

Class

1. Golden Anniversary (period material 1942)
2. St. Anthony Falls (native plant materials)
3. The Blue Victorian (blue flowers)
4. Main Street Show (annuals)
5. The Mill Wheel (mill theme)

EDUCATIONAL DIVISION

Horticultural exhibits of an educational nature regarding a technique or aspect of horticulture are encouraged. Please contact Kent Petterson, 332-1821, to register in advance.

HORTICULTURE DIVISION

HORTICULTURAL DIVISION RULES

1. Entries must be grown and prepared by the exhibitor.
2. An exhibitor may enter more than one horticultural specimen in a single class, provided each entry is a different named variety.
3. Potted plants must have been in the possession of the exhibitor for at least three (3) months.
4. Classes will be divided if the number of entries warrants division.
5. MGCM will furnish clear bottles of appropriate size and pint containers.
6. Vials and Styrofoam slabs will be furnished by the committee for the staging of miniature roses.
7. Only correctly named specimens will be considered for top awards. Correct names on all specimens are desired.
8. Awards will be made on the merits of the entries and, if in any classes there are no entries worthy of awards, the judges may withhold awards.
9. Questions not covered by these rules will be determined by the show chairman.
10. Foliage must be attached to stems of all cut flower exhibits unless the flower is grown with no foliage on the stem (hibiscus, tuberous begonia).
11. Exhibitors are requested not to enter crops which are out of season.

Section A **ANNUALS**

Class

1. Ageratum (5 trusses)
2. Aster (3 blooms)
3. Bachelor Buttons (3 blooms)
4. Celosia
 - A. Plumed (3 spikes)
 - B. Crested (1 spike)
5. Coleus (3 stems)
6. Impatiens (1 stem)
7. Marigolds
 - A. Large, over 3" (3 blooms)
 - B. Medium, 2-3" (1 spray)
 - C. Dwarf, under 2" (1 spray)
8. Nicotiana (3 stems)
9. Pansies (5 stems)
10. Petunias
 - A. Single (3 sprays)
 - B. Double (3 sprays)
11. Salvia (3 branches)
12. Snapdragons
 - A. Tall (3 spikes)
 - B. Dwarf, under 12" (3 spikes)
13. Statice (1 branch)
14. Zinnia
 - A. Pompon, 0.5 to 2" (5 stems)
 - B. Medium, 2.5 to 4" (3 stems)
 - C. Giant, over 4" (3 stems)
15. Any other annual not listed
 - A. Large (1 specimen)
 - B. Small (3 specimens)

Section B **PERENNIALS**

Class

1. Achillea (Yarrow) (3 stems)
2. Echinops (Globe Thistle) (1 branch)
3. Gailardia (Blanket flower) (5 blooms)
4. Gloriosa Daisy (Rudbeckia) (3 blooms)
5. Hibiscus (1 bloom)
6. Hosta
 - A. Leaves under 4" (3 leaves)
 - B. Leaves over 4" across (1 leaf)
7. Liatris (Kansas Gay Feather) (3 spikes)
8. Phlox (3 spikes)
9. Platycodon (Balloon flower)
10. Veronica (3 spikes)
11. Any other perennial not listed
 - A. Large (1 specimen)
 - B. Small (1 specimen)



The Freedom Garden

Gregory P. Smith
President, MGCM



The summer of '92 is upon us at last. The cool and dry spring left many gardens and flower beds dormant, waiting for some warm weather. The lettuce and peas looked great (the ones the rabbits didn't get, that is), however marigolds and impatiens were going nowhere fast. I always plant my tomatoes and coleus on June 1, but with 35 degree nighttime temperatures, I knew I should wait. Finally by the middle of June everything was planted, and it was time to sit back and pray for warm weather and rain. I guess Mother Nature is hard of hearing at her age because we not only got rain and warm weather, we got wind and hail and more rain and more rain and more rain. Now I am back in the garden replanting damaged plants. Maybe this time everything will work out as planned.

The June MGCM meeting at the University of Minnesota Landscape Arboretum was a great evening for all; 80 plus members and their guests enjoyed the beautiful grounds and stately buildings with host Peter Olin, Arboretum

Director and MGCM member. A tasty soup and sandwich meal was served. The guided tram tour was one of the best I have ever personally experienced, with narration by our own Stan Crist.

The 50th Anniversary Garden Tours, scheduled for the 11th and 12th of July, are headed toward a great success. Tickets are starting to move and extra advertising should pay off. The tours are one of the major events of our 50th anniversary celebration. Tour Chair Dave Johnson has guaranteed the weather and gardens will be the best in our Club's 50 year history. What an optimist! Remember, the money raised from the tour will fund MGCM scholarships for students of horticulture. See you on the tour!

Yes, the summer is upon us at last. I think I will just sit back and enjoy it. I learned from a wise man long ago to accept the things I cannot change, to have the courage to change the things I can and to have the wisdom to know the difference between the two.

HELP!

The Fragrance Garden Committee needs a place to dispose of 4 stumps dug from the garden. If no suitable place is found, it will cost approximately \$50 to put them in a landfill. If you can help, call Committee Chair Chuck Carlson at 571-0463.

Stevens House Update

On June 6, MGCM members replanted material damaged by the winter and expanded the garden at the historic Stevens House in Minnehaha Park. Park horticulturist and MGCM member Mary Maguire Lerman and member Terry Robertson planned the work which features plants popular at the time the house was built. Mary, Kent Petterson, Jack Kolb, Bob Kean and Lee Gilligan did the actual planting.

You Would Have Liked...

ARCHIE FLACK



50th Anniversary Feature

by Bill Hull, MGCM Historian

Archie was President of our Club in 1954. He was a fine gardener - no, rather a horticulturist, a graduate of Kew Gardens in England and a life-long student of flora and fauna.

He lived at 4305 Mackey Avenue in St. Louis Park with his dear wife, Ruth, where he showed the world how a true British gardener would present flower beds. It was indeed outstanding. It consisted of a somewhat wandering back border around three rear sides of the backyard with considerable depth in the furthest back portion, behind which he screened cutting beds, compost piles and cold frames.

I remember predominantly annuals, very precisely spaced, yet creating a mass effect. The

height of the flower gradually rose toward the rear with colors in beautiful harmony.

In those days we had a Photography Special Interest Group (as we called them then) and staged demonstration shoots at Archie's. I still have a photo of a group - the only other person I can remember in that photo is past member Eng Hoyme.

As a member and President of MGCM, Archie was very active in starting the Minnesota Landscape Arboretum - he was one of the first to propose such an institution. Archie has been dead a number of years now, but he was another of our great members. You would have liked him, indeed!

Return to:

The Garden Spray of MGCM, Inc.
Andrew J. Marlow, Editor
10700 Minnetonka Boulevard
Hopkins, MN 55343-6744

MEN'S GARDEN CLUB OF MINNEAPOLIS, INC.
CLUB OFFICERS:

President: Gregory P. Smith
1540 Rhode Island Ave. No., Golden Valley, MN 55416
Vice-President: Lee Gilligan
6506 W. Broadway, Brooklyn Park, MN 55428
Secretary: Eldon Hugelen
7473 W. 142nd St. Court, Apple Valley, MN 55124
Treasurer: Melvin C. Anderson
5701 35th Ave. So., Minneapolis, MN 55417
Past President: Merle Thomas Pulley
3852 Pleasant Ave. So., Minneapolis, MN 55409

DIRECTORS:

Jack Kolb
2970 Dodd Road, Eagan, MN 55121
Donald A. Powell
346 13th Ave. No., Hopkins, MN 55343
Robert Stepan
7717 Riverdale Drive, Brooklyn Center, MN 55444
Lloyd C. Wittstock
913 19th Ave. S. E., Minneapolis, MN 55414

First Class Mail

Address Correction Requested